

# RD21XM / RS3020CL

Air-cooled power triode

Output power: 20 kW



**TESLA**  
Electron**Tubes**

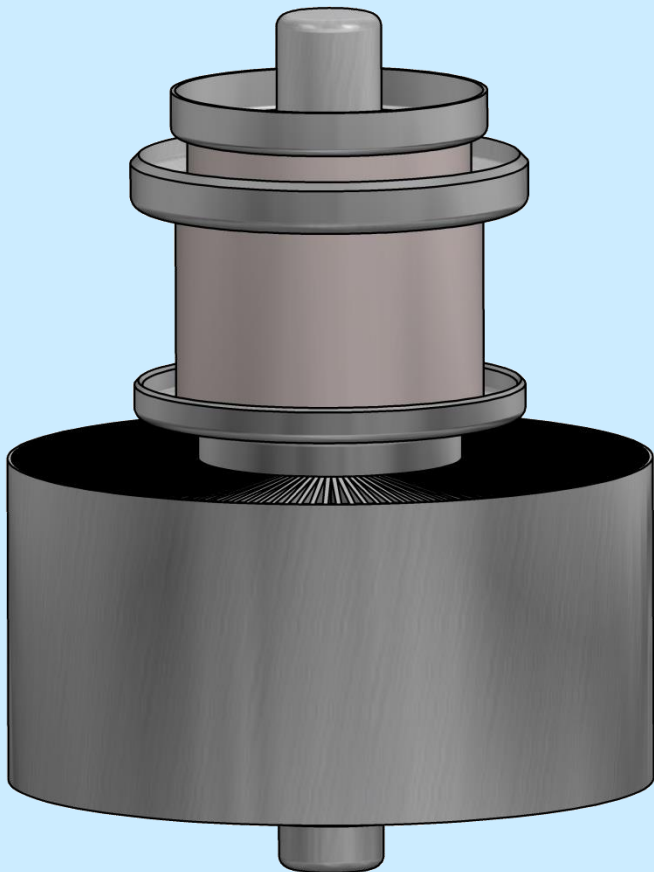

RD21XM is air-cooled triode, made by metal-ceramic technology. This electron tube is intended for industrial generators up to 120 MHz. Application – RF heating, welding or hardening.

Maximum plate dissipation can be 10 kW. Output power is 20 kW in CW mode.

For operation in pulse mode, the parameters depends on equipment characteristics. Contact us for specific information.

# RD21XM / RS3020CL

Air-cooled power triode  
Output power: 20 kW



## Technical specifications

Cathode	WTh	
Filament voltage	5.7	V
Filament current	135	A
Amplification factor	22	
Transconductance	35	mA/V
Capacitance		
• grid-anode	21	pF
• grid-cathode	52	pF
• cathode-anode	1.0	pF

## Maximum ratings

Frequency	120	MHz
Anode voltage		
• < 40 MHz	12	kV
• ≥ 40 MHz	11	kV
Grid voltage	-1300	V
Grid current	0.9	A
Grid dissipation	300-230	W
Anode dissipation	10	kW
Peak cathode current	25	A

## Mechanical characteristics and cooling

Anode cooling	air	
Air inlet temperature	25	°C
Temperature (any point of envelope)	220	°C
Air outlet temperature	75	°C
Air flow	13	m <sup>3</sup> /min
Mounting position	vertical	
Weight	5.6	kg

## Additional accessories\*

- Grid contact ring
- Filament contact rings

\*for detailed information please contact our sales department

\*\*tube with fixed flexible filament contacts is also available (RD21XMF)

## Outline drawing

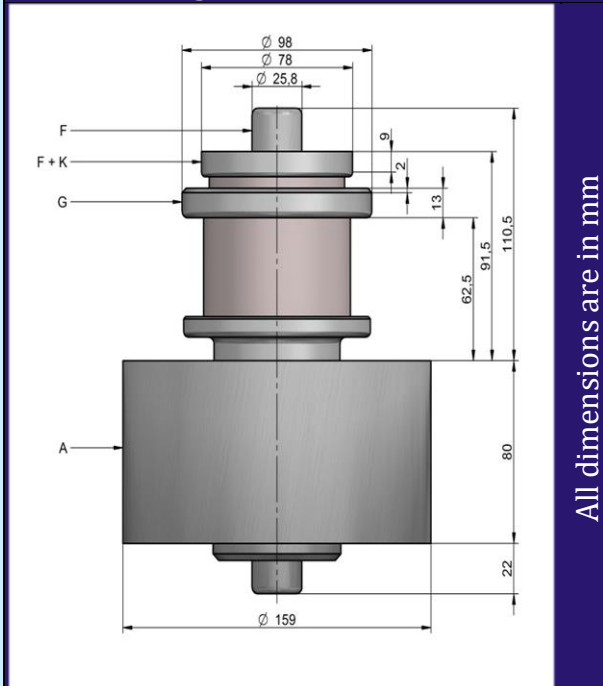

## Constant current characteristics

