

RD25ZM / RS3040CJ

Water-cooled power triode

Output power: 60 kW



TESLA
Electron**Tubes**

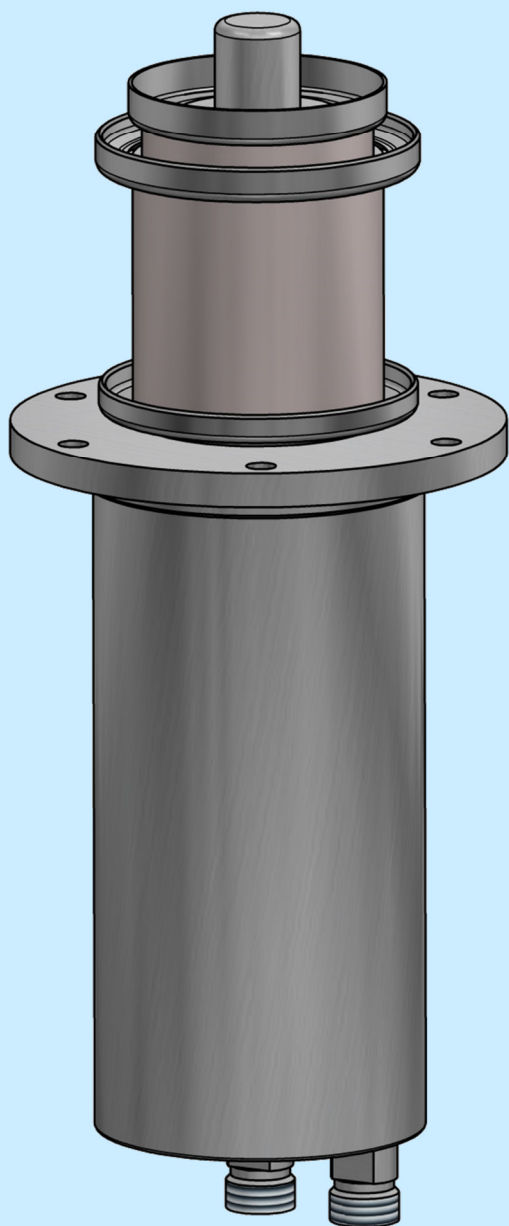

RD25ZM is water-cooled triode, made by metal-ceramic technology. This electron tube is intended for industrial generators up to 100 MHz. Application – RF heating, welding or hardening.

Maximum plate dissipation can be 35 kW. Output power is 60 kW in CW mode.

For operation in pulse mode, the parameters depends on equipment characteristics. Contact us for specific information.

RD25ZM / RS3040CJ

Water-cooled power triode

Output power: 60 kW



Technical specifications

Cathode	WTh	
Filament voltage	8	V
Filament current	185	A
Amplification factor	20	
Transconductance	50	mA/V
Capacitance		
• grid-anode	29	pF
• grid-cathode	78	pF
• cathode-anode	2	pF

Maximum ratings

Frequency	100	MHz
Anode voltage		
• < 30 MHz	14	kV
• ≥ 30 MHz	10-7.5	kV
Grid voltage	-1500	V
Grid current	1.6	A
Grid dissipation	800-600	W
Anode dissipation	35	kW
Peak cathode current	45	A

Mechanical characteristics and cooling

Anode cooling	water	
Water inlet temperature	35	°C
Temperature (any point of envelope)	220	°C
Water outlet temperature	55	°C
Water flow	27	l/min
Mounting position	vertical, anode up or down	
Weight	6.5	kg

Additional accessories*

- Grid contact ring
- Filament contact rings

*for detailed information please contact our sales department

Outline drawing

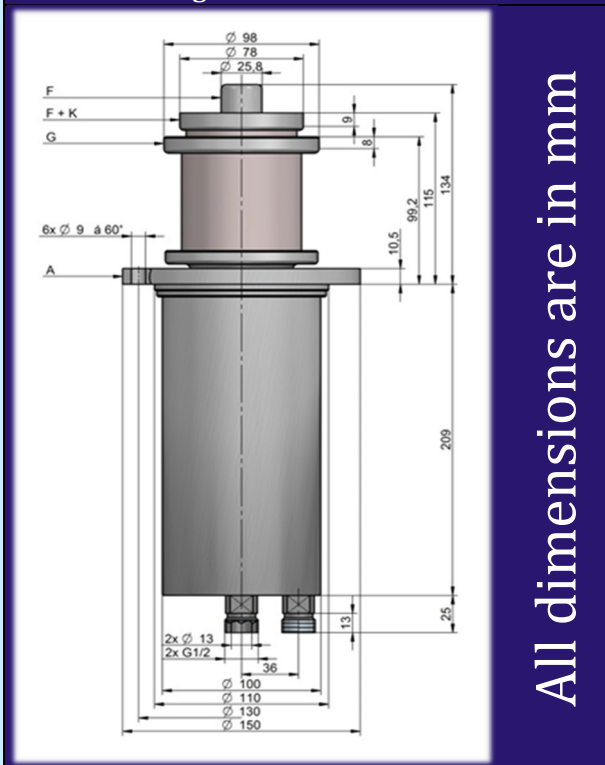

Constant current characteristics

