

# RD26ZM / RS3041CJ

Water-cooled power triode

Output power: 65 kW



**TESLA**  
Electron**Tubes**

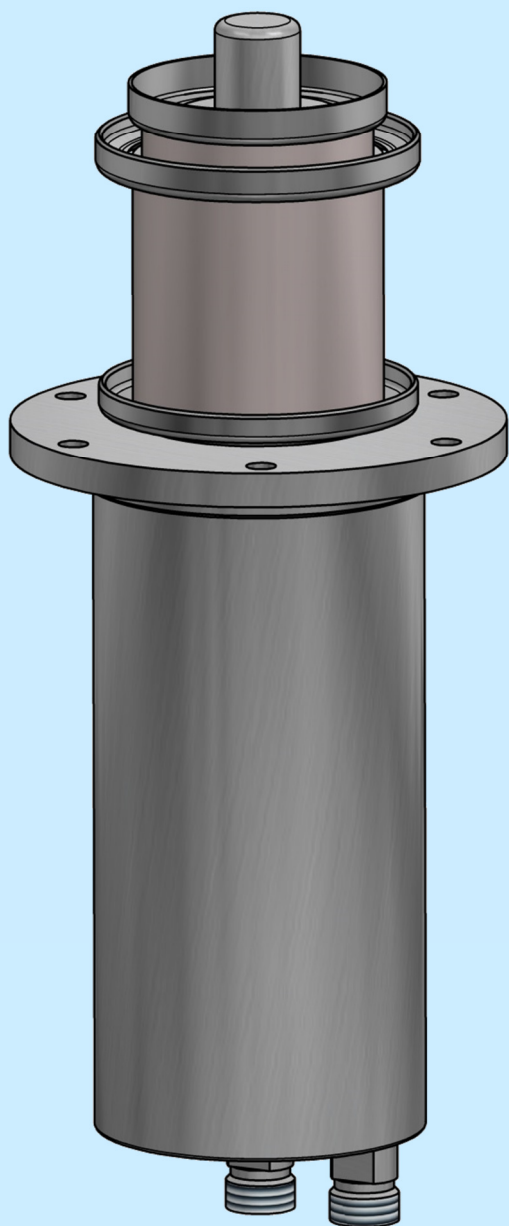

RD26ZM is water-cooled triode, made by metal-ceramic technology. This electron tube is intended for industrial generators up to 100 MHz. Application – RF heating, welding or hardening.

Maximum plate dissipation can be 35 kW. Output power is 65 kW in CW mode.

For operation in pulse mode, the parameters depends on equipment characteristics. Contact us for specific information.

# RD26ZM / RS3041CJ

Water-cooled power triode

Output power: 65 kW



## Technical specifications

Cathode	WTh	
Filament voltage	8	V
Filament current	185	A
Amplification factor	100	
Transconductance	80	mA/V
Capacitance		
• grid-anode	31	pF
• grid-cathode	90	pF
• cathode-anode	0.5	pF

## Maximum ratings

Frequency	100	MHz
Anode voltage		
• < 40 MHz	15	kV
• ≥ 40 MHz	10-12	kV
Grid voltage	-800	V
Grid current	3.3	A
Grid dissipation	1200-700	W
Anode dissipation	35	kW
Peak cathode current	48	A

## Mechanical characteristics and cooling

Anode cooling	water	
Water inlet temperature	35	°C
Temperature (any point of envelope)	220	°C
Water outlet temperature	55	°C
Water flow	27	l/min
Mounting position	vertical, anode up or down	
Weight	8.5	kg

## Additional accessories\*

- Grid contact ring
- Filament contact rings

\*for detailed information please contact our sales department

## Outline drawing

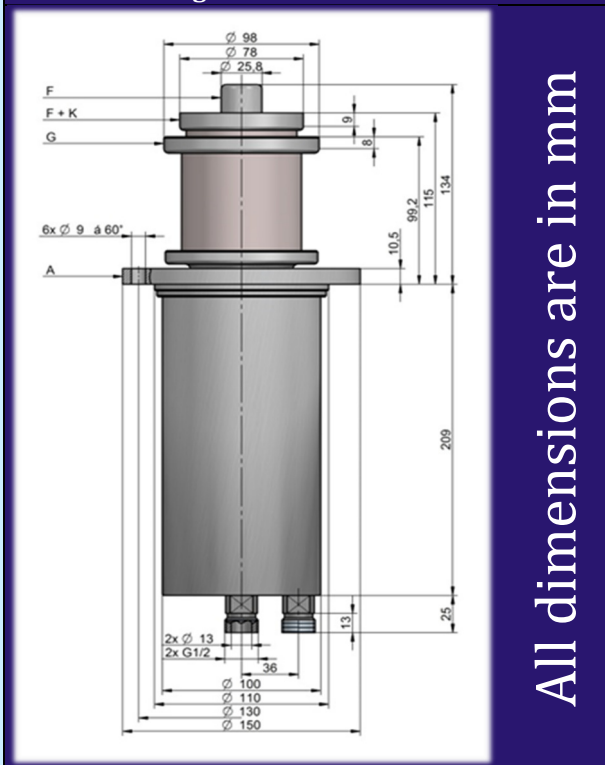

## Constant current characteristics

