

RD5XM / RS3010CL

Air-cooled power triode

Output power: 11 kW



TESLA
Electron**Tubes**

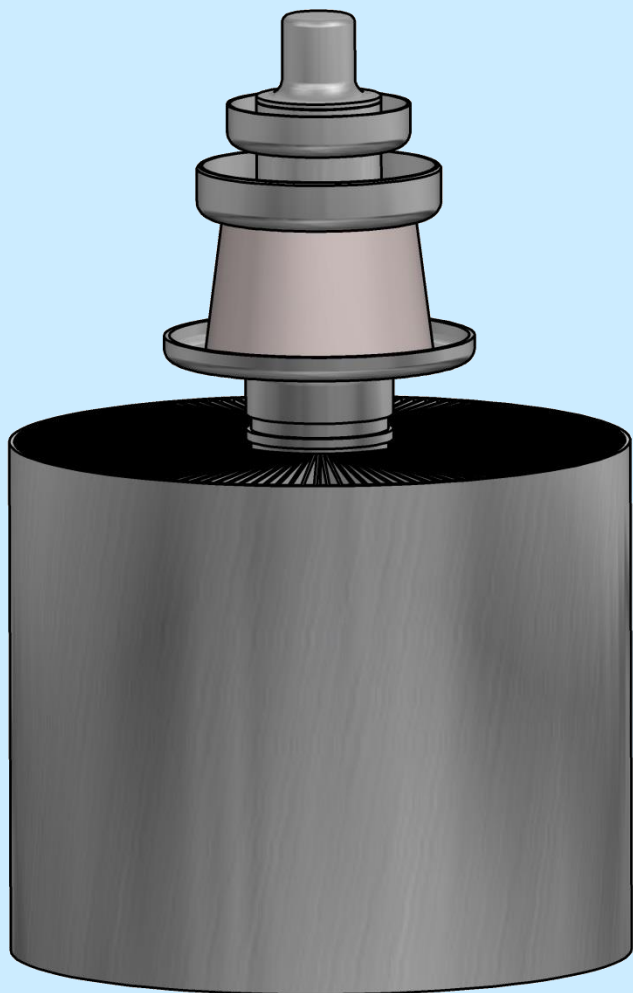

RD5XM is air-cooled triode, made by metal-ceramic technology. This electron tube is intended for industrial RF generators up to 150 MHz.

Maximum plate dissipation can be 5 kW. Output power is 11 kW in CW mode.

For operation in pulse mode, the parameters depends on equipment characteristics. Contact us for specific information.

RD5XM / RS3010CL

Air-cooled power triode

Output power: 11 kW



Technical specifications		
Cathode	WTh	
Filament voltage	6.3	V
Filament current	66	A
Amplification factor	20	
Transconductance	22	mA/V
Capacitance		
• grid-anode	14.5	pF
• grid-cathode	19.5	pF
• cathode-anode	0.5	pF

Maximum ratings		
Frequency	150	MHz
Anode voltage		
• < 85 MHz	7.2	kV
• ≥ 85 MHz	6	kV
Grid voltage	-1000	V
Grid current	550-450	mA
Grid dissipation	200-150	W
Anode dissipation	5	kW
Peak cathode current	10.8	A

Mechanical characteristics and cooling		
Anode cooling	air	
Air inlet temperature	25	°C
Temperature (any point of envelope)	220	°C
Air outlet temperature	100	°C
Air flow	6.5	m ³ /min
Mounting position	vertical	
Weight	3.9	kg

Additional accessories*	
• Grid contact ring	
• Filament contact rings**	
*for detailed information please contact our sales department	
**tube with fixed flexible filament contacts is also available (RD5XMF)	

