

RD5ZM / RS3010CJ

Water-cooled power triode
Output power: 11 kW

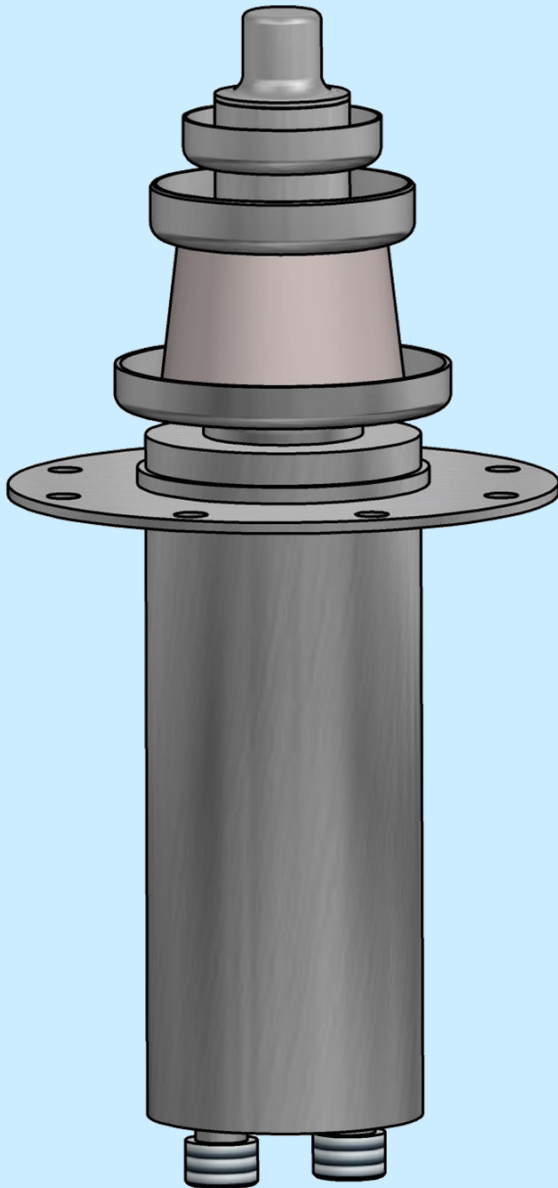

TESLA
Electron**Tubes**



RD5ZM is water-cooled triode, made by metal-ceramic technology. This electron tube is intended for industrial RF generators up to 150 MHz.

Maximum plate dissipation can be 5 kW. Output power is 11 kW in CW mode.

For operation in pulse mode, the parameters depends on equipment characteristics. Contact us for specific information.

